

SİLİNDİR ŞAFTLI
cylindrical shank

TAKIM TUTUCULAR
tool holders



Cardiff

Silindirik Şaftlı Pens Tutucular

Collet Chuck with Cylindrical Shank Bored Through

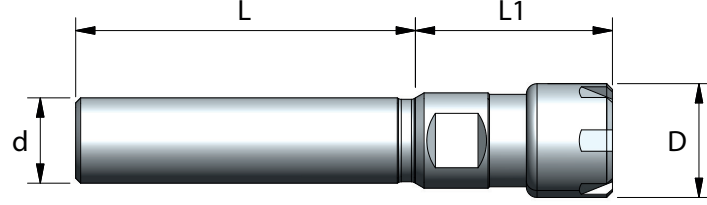

| Sipariş No. Order No. | Ürün Tanımı Product | Sık. Kapasitesi Clamp. Capacity | Tip Type | d | D | L1 | L | Fiyat / Price (€) |
|--------------------------|------------------------|------------------------------------|-------------|----|----|----|-----|----------------------|
| CTT 712.10.08.500 | SS12-ER08-L050-M | 1 - 5 | ER08 | 12 | 12 | 24 | 50 | |
| CTT 712.10.08.100 | SS12-ER08-L100-M | 1 - 5 | ER08 | 12 | 12 | 24 | 100 | |
| CTT 712.10.08.150 | SS12-ER08-L150-M | 1 - 5 | ER08 | 12 | 12 | 24 | 150 | |
| CTT 712.10.11.050 | SS12-ER11-L050-M | 1 - 07 | ER11 | 12 | 16 | 25 | 050 | |
| CTT 712.10.11.100 | SS12-ER11-L100-M | 1 - 07 | ER11 | 12 | 16 | 25 | 100 | |
| CTT 712.10.11.150 | SS12-ER11-L150-M | 1 - 07 | ER11 | 12 | 16 | 25 | 150 | |
| CTT 716.10.11.050 | SS16-ER11-L050-M | 1 - 07 | ER11 | 16 | 16 | 25 | 050 | |
| CTT 716.10.11.100 | SS16-ER11-L100-M | 1 - 07 | ER11 | 16 | 16 | 25 | 100 | |
| CTT 716.10.11.150 | SS16-ER11-L150-M | 1 - 07 | ER11 | 16 | 16 | 25 | 150 | |
| CTT 716.10.16.060 | SS16-ER16-L060-M | 1 - 10 | ER16 | 16 | 22 | 30 | 060 | |
| CTT 716.10.16.100 | SS16-ER16-L100-M | 1 - 10 | ER16 | 16 | 22 | 30 | 100 | |
| CTT 716.10.16.150 | SS16-ER16-L150-M | 1 - 10 | ER16 | 16 | 22 | 30 | 150 | |
| CTT 720.10.16.060 | SS20-ER16-L060-M | 1 - 10 | ER16 | 20 | 22 | 30 | 060 | |
| CTT 720.10.16.100 | SS20-ER16-L100-M | 1 - 10 | ER16 | 20 | 22 | 30 | 100 | |
| CTT 720.10.16.150 | SS20-ER16-L150-M | 1 - 10 | ER16 | 20 | 22 | 30 | 150 | |



Pens Kapağı
Clamping NUT
54



Pens
Collet
46-50



ER Tipi Anahtar Mini
Wrench
56

Silindirik Şaftlı Pens Tutucular

Collet Chuck with Cylindrical Shank Bored Through

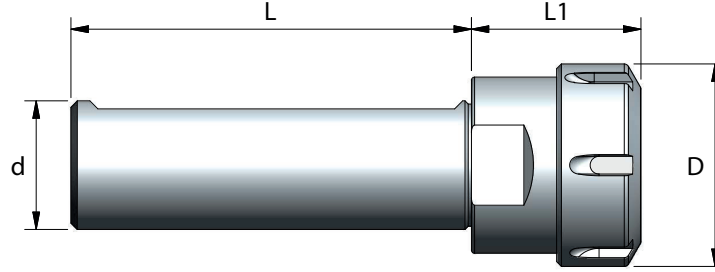

| Sipariş No. Order No. | Ürün Tanımı Product | Sık. Kapasitesi Clamp. Capacity | Tip Type | d | D | L1 | L | Fiyat / Price (€) |
|--------------------------|------------------------|------------------------------------|-------------|----|----|----|-----|----------------------|
| 816.10.16.060 | SS16-ER16-L060 | 1 - 10 | ER16 | 16 | 28 | 30 | 060 | |
| 816.10.16.100 | SS16-ER16-L100 | 1 - 10 | ER16 | 16 | 28 | 30 | 100 | |
| 816.10.16.150 | SS16-ER16-L150 | 1 - 10 | ER16 | 16 | 28 | 30 | 150 | |
| 820.10.16.060 | SS20-ER16-L060 | 1 - 10 | ER16 | 20 | 28 | 30 | 060 | |
| 820.10.16.100 | SS20-ER16-L100 | 1 - 10 | ER16 | 20 | 28 | 30 | 100 | |
| 820.10.16.150 | SS20-ER16-L150 | 1 - 10 | ER16 | 20 | 28 | 30 | 150 | |
| 820.10.25.060 | SS20-ER25-L060 | 2 - 16 | ER25 | 20 | 42 | 40 | 060 | |
| 820.10.25.100 | SS20-ER25-L100 | 2 - 16 | ER25 | 20 | 42 | 40 | 100 | |
| 820.10.25.150 | SS20-ER25-L150 | 2 - 16 | ER25 | 20 | 42 | 40 | 150 | |
| 820.10.32.060 | SS20-ER32-L060 | 2 - 20 | ER32 | 20 | 50 | 53 | 060 | |
| 820.10.32.100 | SS20-ER32-L100 | 2 - 20 | ER32 | 20 | 50 | 53 | 100 | |
| 820.10.32.150 | SS20-ER32-L150 | 2 - 20 | ER32 | 20 | 50 | 53 | 150 | |
| 825.10.16.060 | SS25-ER16-L060 | 1 - 10 | ER16 | 25 | 28 | 35 | 060 | |
| 825.10.16.100 | SS25-ER16-L100 | 1 - 10 | ER16 | 25 | 28 | 35 | 100 | |
| 825.10.16.150 | SS25-ER16-L150 | 1 - 10 | ER16 | 25 | 28 | 35 | 150 | |
| 825.10.25.060 | SS25-ER25-L060 | 2 - 16 | ER25 | 25 | 42 | 50 | 060 | |
| 825.10.25.100 | SS25-ER25-L100 | 2 - 16 | ER25 | 25 | 42 | 50 | 100 | |
| 825.10.25.150 | SS25-ER25-L150 | 2 - 16 | ER25 | 25 | 42 | 50 | 150 | |
| 825.10.32.060 | SS25-ER32-L060 | 2 - 20 | ER32 | 25 | 50 | 53 | 060 | |
| 825.10.32.100 | SS25-ER32-L100 | 2 - 20 | ER32 | 25 | 50 | 53 | 100 | |
| 825.10.32.150 | SS25-ER32-L150 | 2 - 20 | ER32 | 25 | 50 | 53 | 150 | |



Pens Kapağı
Clamping NUT
54



Pens
Collet
46-50



ER Tipi Anahtar
Wrench
56

Silindirik Şaftlı Pens Tutucular

Collet Chuck with Cylindrical Shank Bored Through

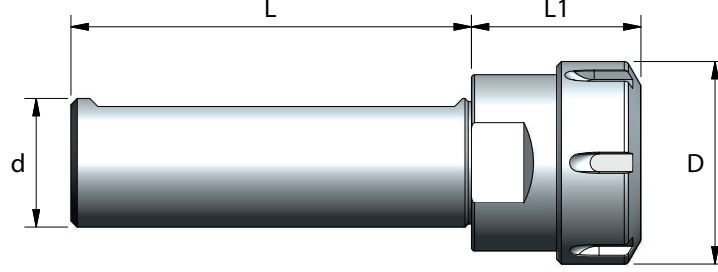

| Sipariş No. Order No. | Ürün Tanımı Product | Sık. Kapasitesi Clamp. Capacity | Tip Type | d (mm) | D (mm) | L1 (mm) | L (mm) | Fiyat / Price (€) |
|--------------------------|------------------------|------------------------------------|-------------|-----------|-----------|------------|-----------|----------------------|
| CTT 832.10.25.060 | SS32-ER25-L060 | 2 - 16 | ER25 | 32 | 42 | 50 | 060 | |
| CTT 832.10.25.100 | SS32-ER25-L100 | 2 - 16 | ER25 | 32 | 42 | 50 | 100 | |
| CTT 832.10.25.150 | SS32-ER25-L150 | 2 - 16 | ER25 | 32 | 42 | 50 | 150 | |
| CTT 832.10.32.060 | SS32-ER32-L060 | 2 - 20 | ER32 | 32 | 50 | 53 | 060 | |
| CTT 832.10.32.100 | SS32-ER32-L100 | 2 - 20 | ER32 | 32 | 50 | 53 | 100 | |
| CTT 832.10.32.150 | SS32-ER32-L150 | 2 - 20 | ER32 | 32 | 50 | 53 | 150 | |
| CTT 832.10.40.070 | SS32-ER40-L070 | 2 - 26 | ER40 | 32 | 63 | 63 | 070 | |
| CTT 832.10.40.100 | SS32-ER40-L100 | 2 - 26 | ER40 | 32 | 63 | 63 | 100 | |
| CTT 832.10.40.150 | SS32-ER40-L150 | 2 - 26 | ER40 | 32 | 63 | 63 | 150 | |
| CTT 840.10.32.100 | SS40-ER32-L100 | 2 - 20 | ER32 | 40 | 50 | 30 | 100 | |
| CTT 840.10.32.150 | SS40-ER32-L150 | 2 - 20 | ER32 | 40 | 50 | 30 | 150 | |
| CTT 840.10.40.070 | SS40-ER40-L070 | 2 - 26 | ER40 | 40 | 63 | 63 | 070 | |
| CTT 840.10.40.100 | SS40-ER40-L100 | 2 - 26 | ER40 | 40 | 63 | 63 | 100 | |
| CTT 840.10.40.150 | SS40-ER40-L150 | 2 - 26 | ER40 | 40 | 63 | 63 | 150 | |



Pens Kapağı
Clamping NUT
54



Pens
Collet
46-50



ER Tipi Anahtar
Wrench
56